

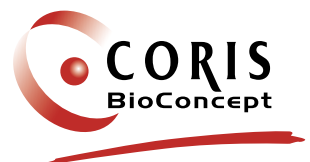

Mefloquine-Strip

Rapid diagnostic test for *in vitro* detection of Mefloquine in urine

- Easy to read
- Rapid (10')
- Specific
- Sensitive
- No equipment required
- No dilution



www.corisbio.com

Mefloquine-Strip

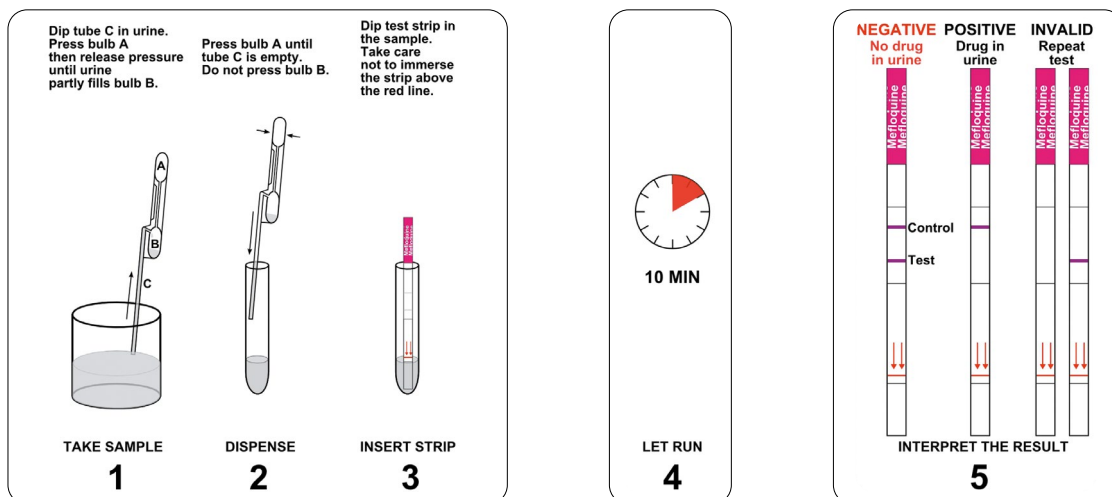

Performance of the kit

82 urines containing Mefloquine have been collected and tested on the spot (Chad and Equatorial Guinea). All MQ-strip show the presence of Mefloquine in urine.

The presence of Mefloquine in 77 of these urine samples was confirmed in France by HPLC (High Performance Liquid Chromatography).

The detection limit of Mefloquine ranges from 1 to 5 µg/mL.

For more technical information

client.care@corisbio.com

Ordering Information

| PRODUCT NAME | DESCRIPTION | STORAGE | CODE |
|------------------|--------------|-------------|--------|
| Mefloquine-Strip | 20 tests/kit | 4°C to 30°C | C-10T2 |

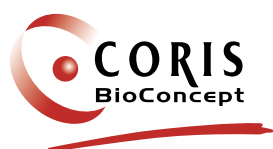

CREALYS Science Park
Rue Guillaume Fouquet 11
5032 Gembloux - BELGIUM
T +32 (0)81 719 910 - F +32 (0)81 719 919
sales@corisbio.com - www.corisbio.com

— Distributed by —



MADE IN BELGIUM

D-CUS-10-T2-S/04
March 2023